

Cervical Sample Collector(Kit)

Introduction

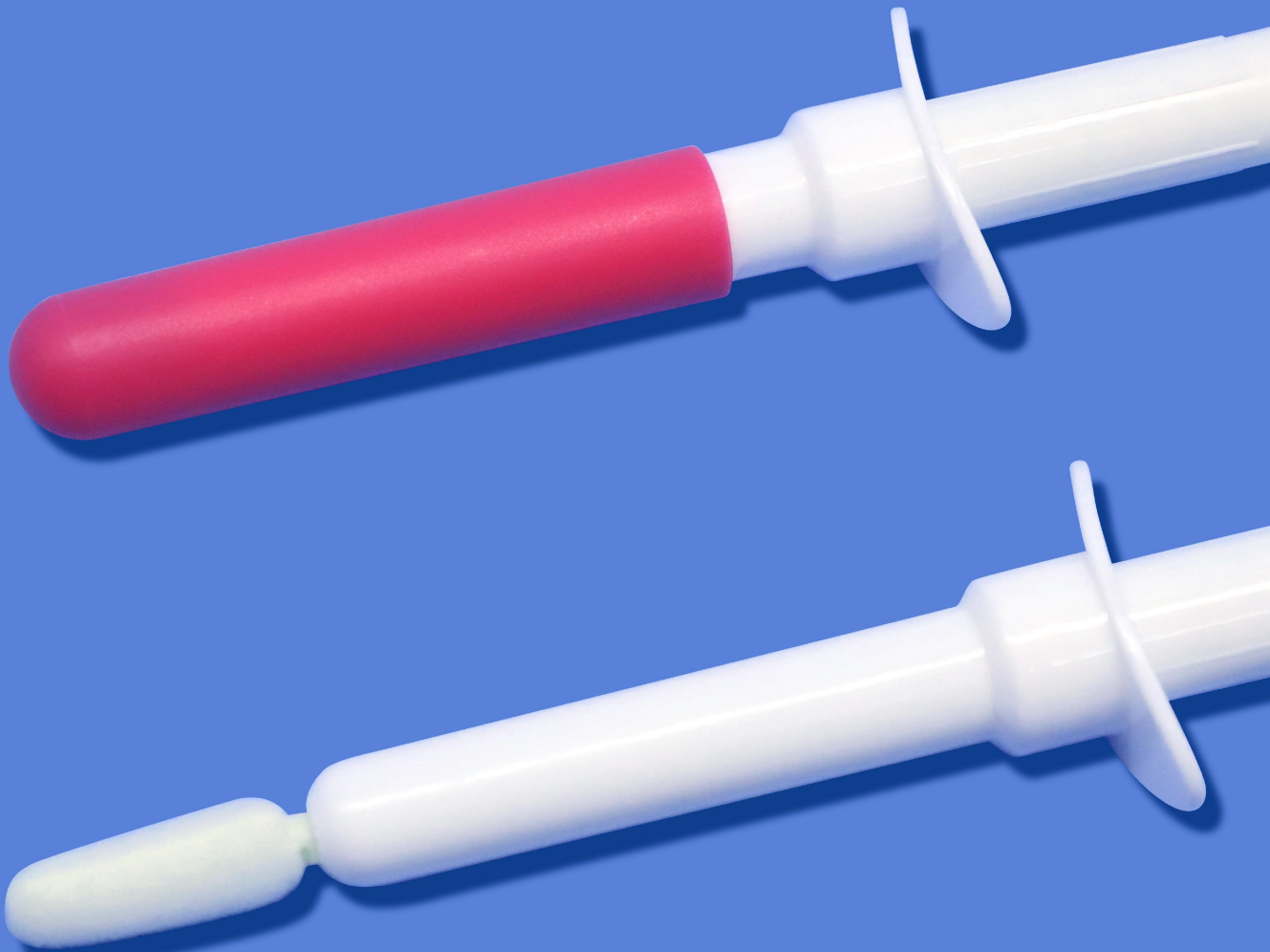

Product Information

Product Name:	Disposable Sampling Kit
Intended Use:	Cervical specimen collection , self-collection
Application:	Specimen PCR test, EIA, Virus Culture, Disposable Gynecological Examination
Material:	Medical Foam Tip , ABS Stick and Sleeve, Tube
Sterilization:	Irradiation
Validity:	2 years

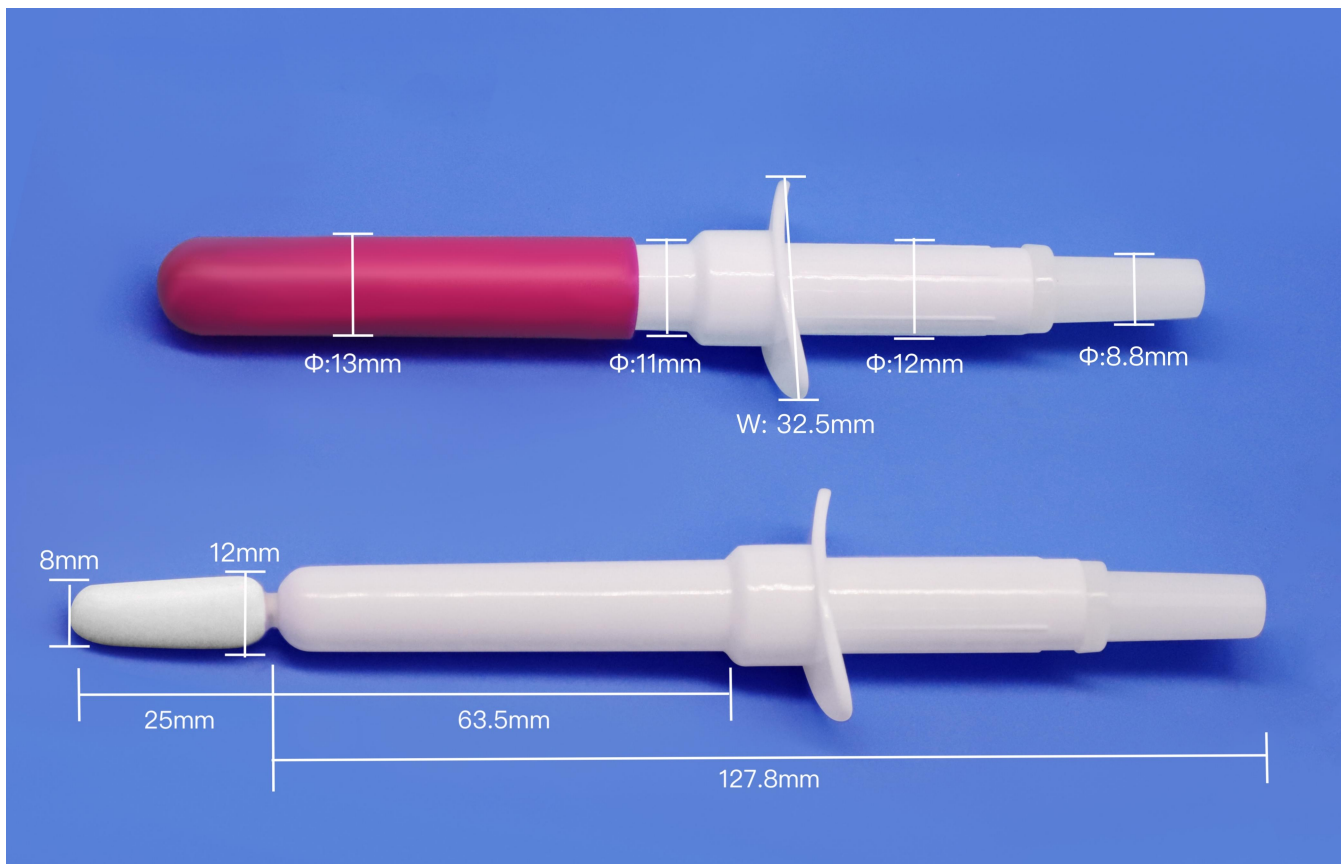

Collection Steps

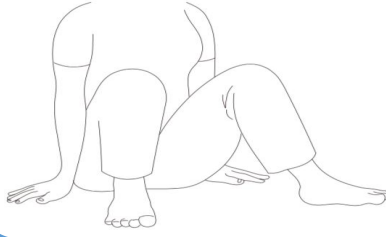

Sampling in a semi-sitting position.

Open the package of this product, take out the sampling swab, and remove the sleeve.

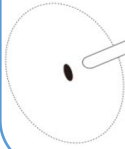
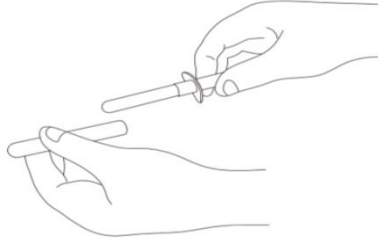

The operator holds the bottom of the handle and slowly inserts the swab from the vagina until the safety flap touches the orificium vaginae.

Note: The sampling head here is not rotated out.

Rotate the handle 6-7 turns clockwise to unscrew the sampling head for vaginal sampling.

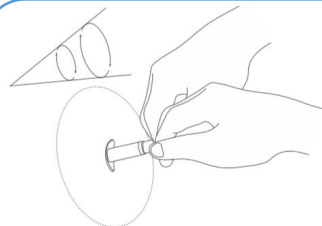
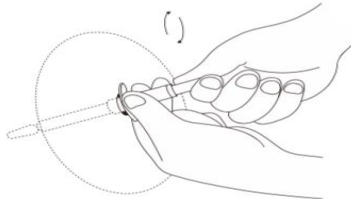

Hold the handle and twist 4-5 turns in the same direction.

NOTE: During twisting, keep the safety flap touching the orificium vaginae.

Gently withdraw the sampling swab from the orificium vaginae and break the sampling head into the preservation liquid tube.

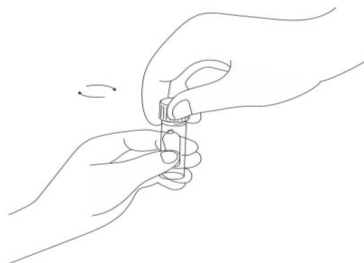
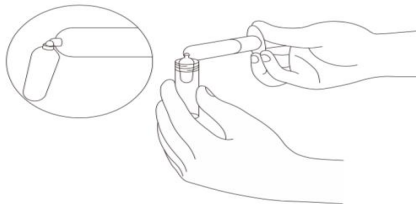

Tighten the pipe cover and indicate the collection information.

Cautions

No sexual life history; Avoid using in period of menstrual, pregnancy and lactation;

- - Avoid the use by women with genital tract lesions (injury, surgery, inflammation, tumor) or who have recently undergone cervical surgery (cryotherapy, electrocination, tapering, laser). Acute cervicitis should be treated first, and then sampled after recovery;
 - Do not have sex or bath for 24 hours before sampling; Vaginal irrigation or intravaginal medication should not be performed within 3 days prior to sampling;
 - Those who are in critical condition and may be in danger of life during the examination;
 - This product is a disposable product with independent packaging, only for personal use, one kit for one person, not allowed to share.
 -
 - Do not use when the independent packaging is damaged, the sampling head is exposed to the tube or the sampling head is separated from the tube;
 - The product has been used by a large number of people, and the sampling swab operation is safe and painless, but it is still recommended to do it in the company of others;
 - If bleeding or persistent pain occurs during sampling, please stop the operation immediately and go to the hospital for treatment.
 - When using, pay attention to the expiry date of the product, the expired product is strictly prohibited to use;
 - Pay attention to the packaging mark and check whether the package is damaged. If damaged, it is strictly prohibited to use.
 - Dispose according to medical waste treatment method after use.
-

Product Display



